

Shield Removal

<Pinlock Sheet & Tear off Film>

When putting on both tear off film and Pinlock sheet, the tear off film should be installed first and then Pinlock sheet. (The tear off film cannot be installed after installing the Pinlock sheet.)

1

Lift up the handle-locker.

2

Open shield to the maximum open position.

3

Push the handle-locker to the open position. The shield will be automatically released out of base ratchet mechanism.

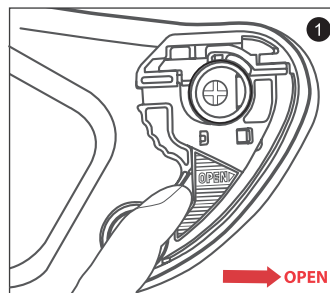
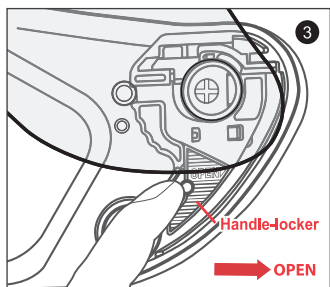
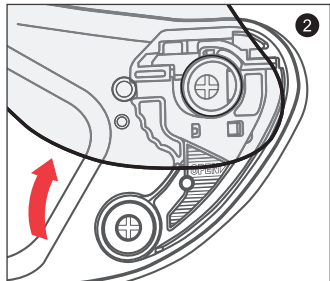
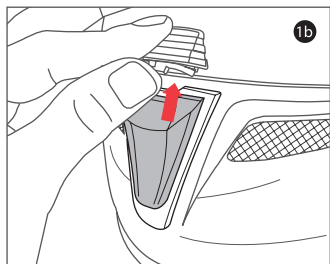

Shield Installation

1

Ensure that the handle-locker is in the open position

2

Align and insert the top of the shield guide into the plate-gear guide.

3

With the guides properly aligned, press the lower section of the shield into the plate-gear mechanism. The locking tab should pop into position, locking the shield into place.

